

MURRAY COUNTY.

Section 7
 10798 McGill-Warner Co., Blank Book Manufacturers, St. Paul.

Township 106

Range 43

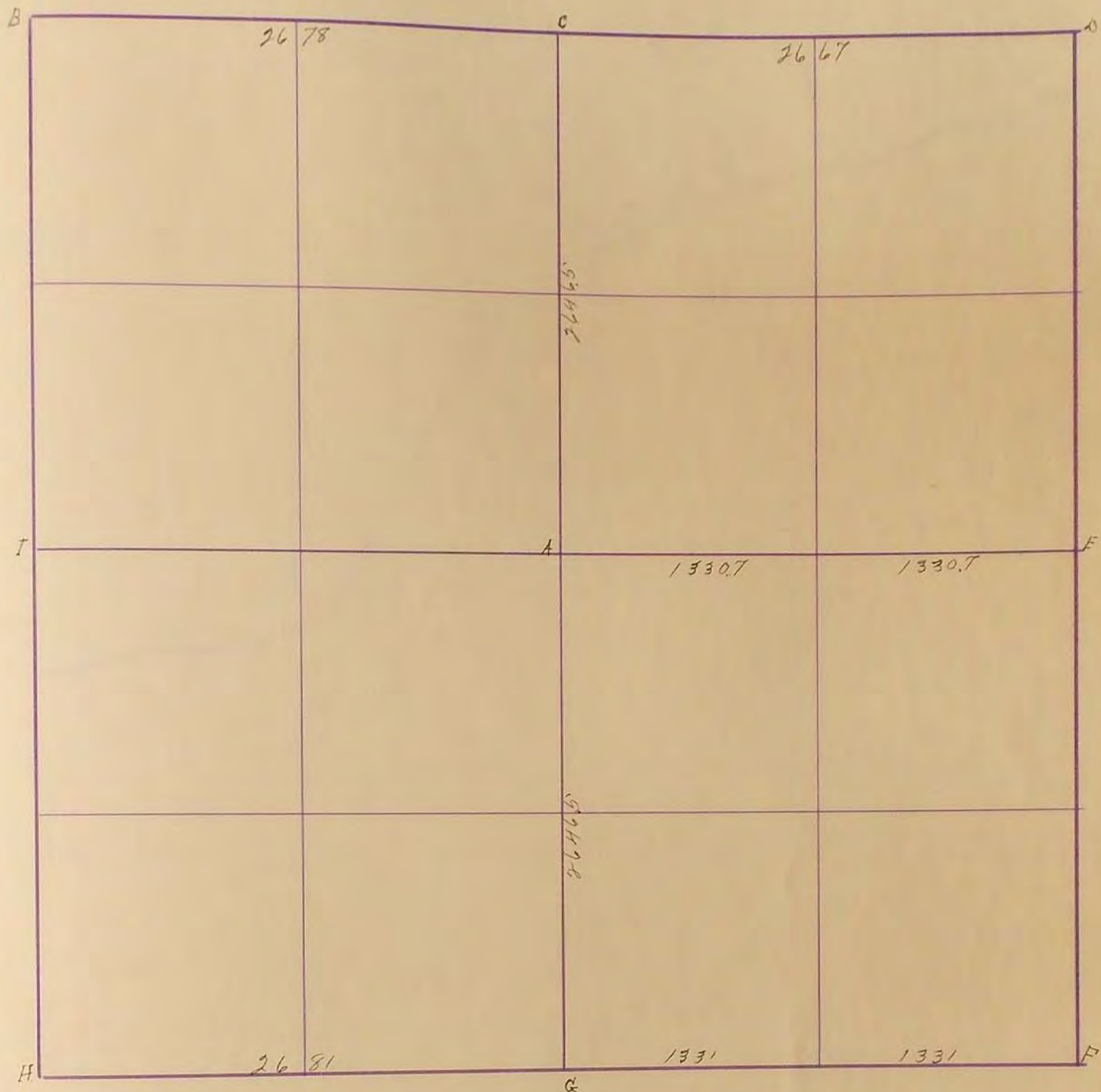

Oct 26 1901

- A. Stone 8x10x12 + mound Hard Grey
 - B. " in grade
 - C. 2 " and mound Stone + Iron stakes 32 1/2' N. + 3' W. of F. Cor.
 - D. For mound Stake Bits + Stone Fence Post 36' NE Fence Post 34 1/2' E.
 - E. " " " " " "
 - F. " Stake mound + Bits Small lime stones in bottom stone - Coping 4x6x16 Grey
 - G. Stone in grade 10x14x20
 - H. " " " " " " F. Cor. NE 46 1/2'
 - I. Stake + est. BY PIPESTONE, Mqn. O.K.
 - X. Stones
- For stakes at B, D, E, F, H.
- Stakes marked by Previous survey B, C, D, H, I.
- Established (B.A.G.A.) *J.H. Woolstencroft*

6
7
8
9
10
11
12
13
14
15
16
17
18
19
20
21
22
23
24
25
26
27
28
29
30
31
32
33
34
35
36

SURVEY No. _____

Section 7

Town 106

Range 43

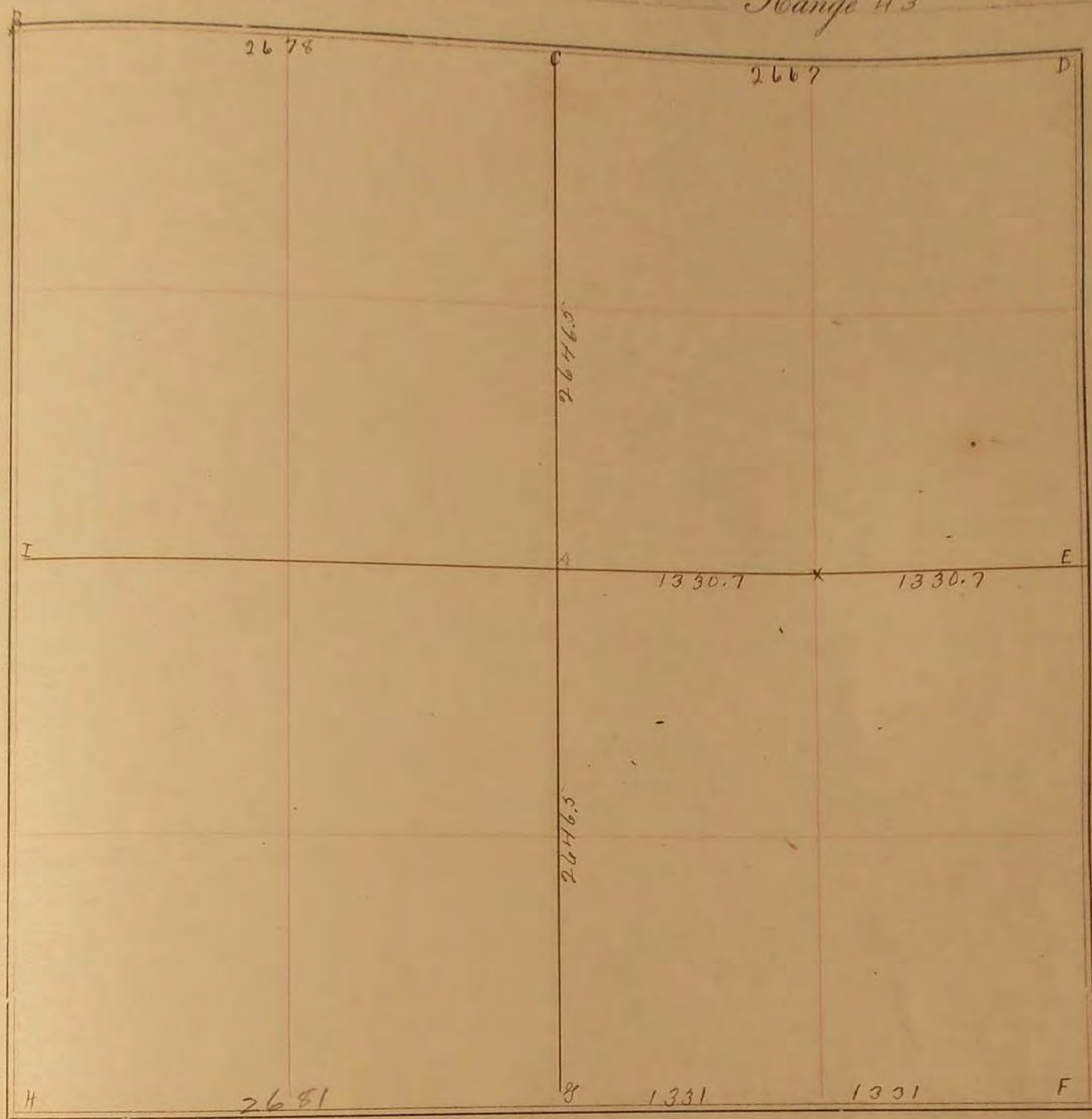

FIELD NOTES.

OCT. 25, 1901.

- A Stone 8x10x12 + mound HARD GREY
- B " in GRADE
- C " and mound stone + iron stake 32 1/2' N + 3' W. of Fence cor.
- D Gov mound, STAKE, PILS + stone Fence post 36' N-E, Fence post 34.5 S.E.
- E " " " " " " " " " " " "
- F " STAKE mound + pits. small lime stones in bottom, stone projecting 4x4x16, grey.
- G Stone in GRADE 10x14x20
- H " " " " " " " " " " " "
- I STAKE set by pipe stone man, O.K.
- X STONES.
- Gov. STAKES AT B, D, E, F, H.
- STAKES MARKED by previous SURVEY B, C, D, H, I.
- ESTABLISHED A.A.

J. W. Woolstener